

LED T8 EXTERNAL DRIVER
EXTERNAL DIMMABLE T8 PLASTIC SERIES
UL TYPE-C



1-LAMP DRIVER



2-LAMPS DRIVER



3-LAMPS DRIVER



4-LAMPS DRIVER

PRODUCT DESCRIPTION:

MaxLite LED T8 with External Driver are the ideal energy saving choices when upgrading traditional linear T8 fluorescent lamps in fixtures containing standard G13 (medium bi-pin) sockets.

FEATURES:

- 11.5W (Bare Lamp), 13W (System), 1800 lumens
- Efficacy (lm/W): ≥ 138
- Color Temperature available: 3500K, 4000K and 5000K
- Universal Voltage: 120V-277V
- Instant on
- Beam Angle: 330°
- Dimmable: Yes, 0-10V
- Color Rendering Index (CRI): ≥ 82
- Rated Lifetime: 50,000 hours
- Polycarbonate lens, shatter resistant
- THD: $< 20\%$
- High power factor: ≥ 0.90
- Base: G13 medium bi-pin
- Mercury free and virtually no UV or IR light
- Suitable for open or enclosed fixtures
- Suitable for dry and damp locations
- Five year limited warranty

APPLICATIONS:

- General illumination
- Cove lighting
- Display case
- High bay
- Parking garage



SPECIFICATIONS:

ITEM	SPECIFICATION	4 - FOOT - DETAILS
GENERAL PERFORMANCE	Power Consumption (bare lamp)	11.5W
	System Power	13W
	Lumens Delivered	1,800lm
	Efficacy	≥138 lm/W
	CRI	82
	Beam Angle	330°
	Color Temperature (CCT)	3500K, 4000K & 5000K
	Lumen Maintenance (L70)	50,000 Hours
ELECTRICAL	Power Factor	≥ 0.90
	Input Voltage	120V-277V, 50/60 Hz
PHYSICAL	Operating Temperature	-4°F to 113°F
	Lens	Opal (Frosted)
	Base	Medium Bi-Pin (G13)
CERTIFICATION	Certification	DLC 4.4, ETL Classified
	Material Usage	RoHS compliant; no mercury
	Environment	Dry or Damp
	Warranty	5 Years

Lighting layouts and spacing criteria available upon request

ORDERING:

ORDER CODE	MODEL	DLC PRODUCT ID	BARE LAMP WATTS	SYSTEM WATTS	LUMENS	EFFICACY	CCT
1 - LAMP KIT							
14099902	L11.5T8EX435DDR1L11	PXU20GSD					3500K
14099906	L11.5T8EX440DDR1L11	PTNODZDF	11.5W	13W	1,800 lm	138 lm/W	4000K
14099910	L11.5T8EX450DDR1L11	PG84ZQA1					5000K
2 - LAMP KIT							
14099903	L11.5T8EX435DDR2L11	PLFQIC8T					3500K
14099907	L11.5T8EX440DDR2L11	PF82WL6D	11.5W	13W	1,800 lm	138 lm/W	4000K
14099911	L11.5T8EX450DDR2L11	PPBLNP4R					5000K
3 - LAMP KIT							
14099904	L11.5T8EX435DDR3L11	PPA9EU6Z					3500K
14099908	L11.5T8EX440DDR3L11	PDFJIFJT	11.5W	13W	1,800 lm	138 lm/W	4000K
14099912	L11.5T8EX450DDR3L11	PI0XKXJL					5000K
4 - LAMP KIT							
14099905	L11.5T8EX435DDR4L11	PM38RMDK					3500K
14099909	L11.5T8EX440DDR4L11	PAMOO5IE	11.5W	13W	1,800 lm	138 lm/W	4000K
14099913	L11.5T8EX450DDR4L11	POCCX12R					5000K

ACCESSORIES			
ORDER CODE	MODEL NUMBER	DESCRIPTION	ACCESSORIES IMAGE
73978	G13LPNS	G13 Low Profile Non-Shunted Lamp Holder	

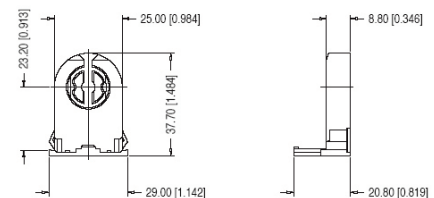

Specifications are subject to change without notice.